

Wall Section Project, Part One: Framing

Names: _____

Date: _____

1. Build the wall section according to the framing details provided.
2. Note the overall sizes and stud and joist spacing.
3. Prepare a cutting list on the back of this page detailing the number and size of the floor joists, header joists, studs, cripple studs, top and bottom plate, double top plate, lintel and the aspenite subfloor.
4. Use the framing assessment sheet as a guide to build this project.

Framing Assessment:

- | | |
|--|-----------------|
| 1. Overall dimensions 48" x 26 ½" x 52 ½". |/6 |
| 2. Squareness of floor. |/4 |
| 3. Squareness of walls. |/8 |
| 4. Aspenite flush with floor framing. |/2 |
| 5. Correct joist spacing 16" O/C. |/4 |
| 6. Correct stud spacing 16" O/C. |/6 |
| 7. Walls flush with edge of floor. |/2 |
| 8. Double top plate installed correctly. |/2 |
| 9. Walls connected properly using corner stud. |/4 |
| 10. But joints are square and flush. |/10 |
| 11. Includes required bracing. |/2 |
| 12. Correct floor nailing. |/4 |
| 13. Correct wall nailing. |/6 |
| Total: |/60 |

WALL SECTION FRAMING DETAIL

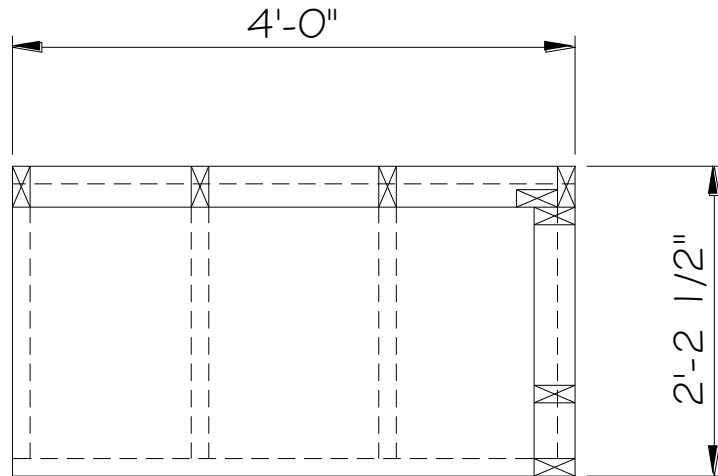

TOP VIEW

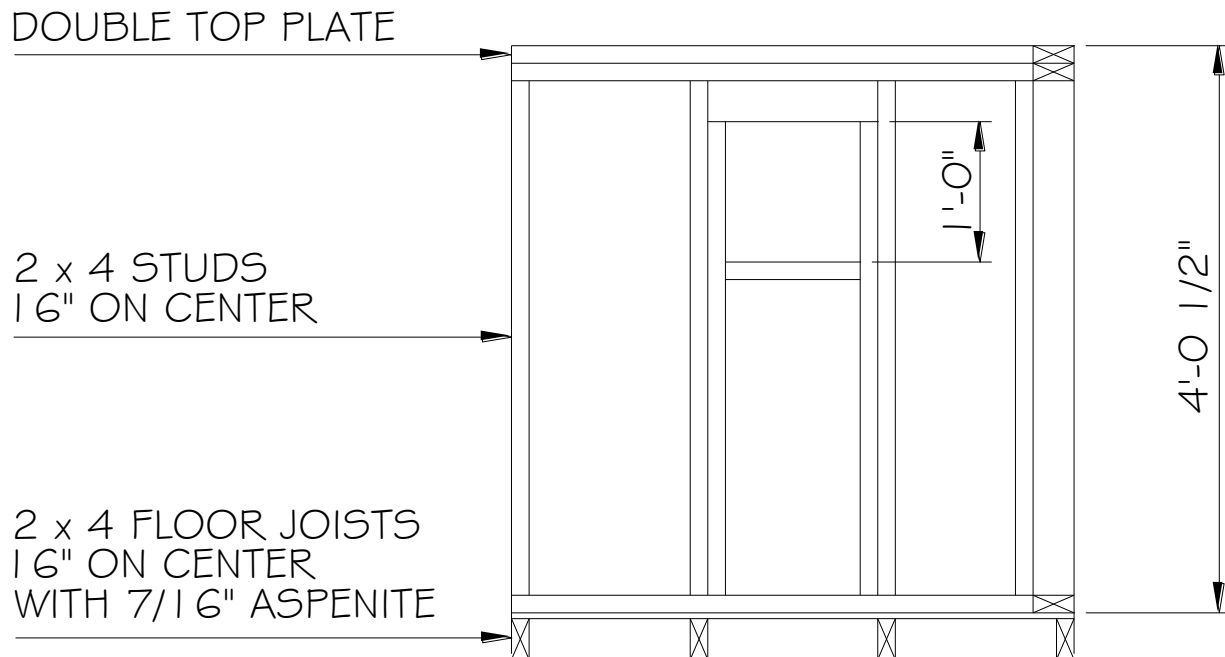

FRONT VIEW